

INDUSTRIAL RACKMOUNT COMPUTER IRC-100 SERIES



Industrial Rackmount Computer with Intel® Core™ i7 8th or 9th Generation Processor via socket 1151, Q370 Chipset, Supports: 2- Removable 2.5" SATA drives, 2- DisplayPorts, 1- HDMI, 2- GbE LAN, 4- USB 3.1 Gen2, 4- USB 3.1 Gen1, 2- USB 2.0, TPM2.0, 2- PCI Express: 2.5GbE PoE, 10GbE Network, 5G Cellular, Fanless Design



High Performance



Multi-Processor Support



PoE & 10GbE Network Support



Triple Monitor Support



Fanless



5G Ready

SYSTEM SPECIFICATIONS

Processor	Intel® 8th Generation i7-8700T 4.00GHz Max Intel® 9th Generation i7-9700T 4.30GHz Max
Processor Generation	Coffee Lake-S™
Processor Cores	6 • i7-8700T 8 • i7-9700T
Memory	Up to 64GB DDR4L SO-DIMM
Storage	1 • M.2 SSD up to 4TB (RAID 10 Support) 2 • Removable external 2.5" 3.0 SATA drive bay up to 4TB (RAID 0/1/5/10 Support)
Chipset	Q370
Graphics	Intel® HD Graphics
LAN Controller	Intel® I219-LM GbE LAN port-PHY Intel® I210-AT GbE LAN
System I/O	Front 1 • Power Button 2 • USB 2.0 ports 2 • Removable external 2.5" 3.0 SATA drive bay Black 2 • PCI Express Slots 2 • DisplayPort 1 • HDMI 4 • USB 3,1 Gen2 ports 4 • USB 3.1 Gen1 ports 2 • GbE LAN Ports 1 • Line-in 1 • Line-out 1 • Mic 1 • Power Connector
BIOS	AMI
Watchdog Timer	256 levels, 1~255 sec.
Expansion Interface	1 • PCIe Mini Card (full height) 1 • M.2 E Key 2 • PCI Express Slots x 16
System Indicator	1 • blue LED for system power-on 1 • amber LED for SSD active

MECHANICAL SPECIFICATIONS

Color	Blue & Silver
Construction	Aluminum alloy with heavy steel
Dimensions (W x H x D)	431.8mm x 43.8mm x 304.8mm (17.00" x 1.70" x 12.00")
Mounting	Rail Mount (optional)

POWER SUPPLY

Power Input	Integrated 400W Power Supply
-------------	------------------------------

FEATURES

- Intel® 8th & 9th Generation 6- Core & 8- Core processors 4.0GHz~4.30GHz Max
- 64GB DDR4 SO-DIMM max
- 1• M.2 SSD up to 4TB (RAID 10 Support)
- 2• Removable 2.5" SATA 3.0 ports up to 4TB each (RAID 0/1/5/10 Support)
- 4• 3.1 USB Gen2 ports, 4• 3.1 USB Gen1 ports, 2• 2.0 USB ports
- 2• GbE LAN, 4• 3.1 USB Gen2 ports, 4• 3.1 USB Gen1 ports, 2• 2.0 USB ports
- 1• 5G Cellular (optional)
- 1• 4 Port 2.5GbE PoE Module (optional)
- 1• 10GbE 2 or 4 Port Intel® Network Adapter (optional)
- TPM2.0
- Fanless Design

REGULATORY SPECIFICATIONS

Operating Temperature	0°C ~ 60°C (32°F ~ 140°F)
EMI/EMC	CE standards applied (EN 55022 / EN 55024 / EN 55032) FCC 47 CFR Part 15 (Class A) RoHS
Vibration	Operating: 1G 5-500Hz, 3 Axes according to IEC60068-2-64

ORDERING INFORMATION

Base	IRC-100 1U Industrial Rackmount Computer - Fanless, Supports 8th / 9th Gen Coffee Lake-S Series Processors, Intel Q370 Chipset, 1- Power button, 4- USB 3.1 Gen1, 4- USB 3.1 Gen2 Ports, 2- USB 2.0 Ports (Front), 1- Intel I210-AT GbE LAN Port, 1- Intel I219LM GbE LAN, 2- DP Port, 1- HDMI, 1- Audio Jack: (Line-In) (Line-Out) (Mic-In), 1- PCIe x16, 1- PCIe x 4, 1- M.2, Integrated 400W Power Supply, (Does not include Power Cord)
IRC-100_	

CONFIGURABLE & ACCESSORIES

Processor	Intel® i7-8900T 4.00GHz Max, Intel® i7-9700T 4.3GHz Max
M.2 SSD	250GB, 500GB, 1TB, 2TB, 4TB
1 • 2.5" SATA SSD	250GB, 500GB, 1TB, 2TB, 4TB
DDR4 SO-DIMM	8GB, 16GB, 32GB, 64GB Windows® 10 IoT Enterprise 2021 LTSC High End (i7/i9), Windows® 10 Professional 64bit, Windows® 11 IoT Enterprise 2024 LTSC High End (i7/i9), Windows® 11 Professional 64bit, Ubuntu® Desktop 22.04 LTS 64bit, Ubuntu® Server 22.04 LTS 64bit
Operating System	Intel® Wi-Fi 6 AX200 Wi-Fi / Bluetooth M.2 Module
WiFi module	2 • PCI Express Module x16 4- Port USB 3.0 to PCI Express Card Expansion card 4- Port 2.5GbE PoE Module 2- Port Intel® 10GbE Network Module 4- Port Intel® 10GbE Network Module (Verizon®) 5G Embedded Quectel RM520N-GL, Includes: 4- 5G Antennas (AT&T®, T-Mobile®) 5G Embedded Quectel® RM520N-GL, Includes: 4- 5G Antennas
Sliding Rail Kit	6610030321
Power Cord	US Power Cord, Black, 6ft EU Power Cord, Black, 6ft UK Power Cord, Black, 6ft AU Power Cord, Black, 6ft

INDUSTRIAL RACKMOUNT COMPUTER IRC-100 SERIES



WARRANTY

Standard Warranty	2 Year Manufacturer Warranty
Extended Warranty	TotalCare Protection 3 or 5 Year Extended
Expected Life Cycle	5 Years

DIMENSIONS

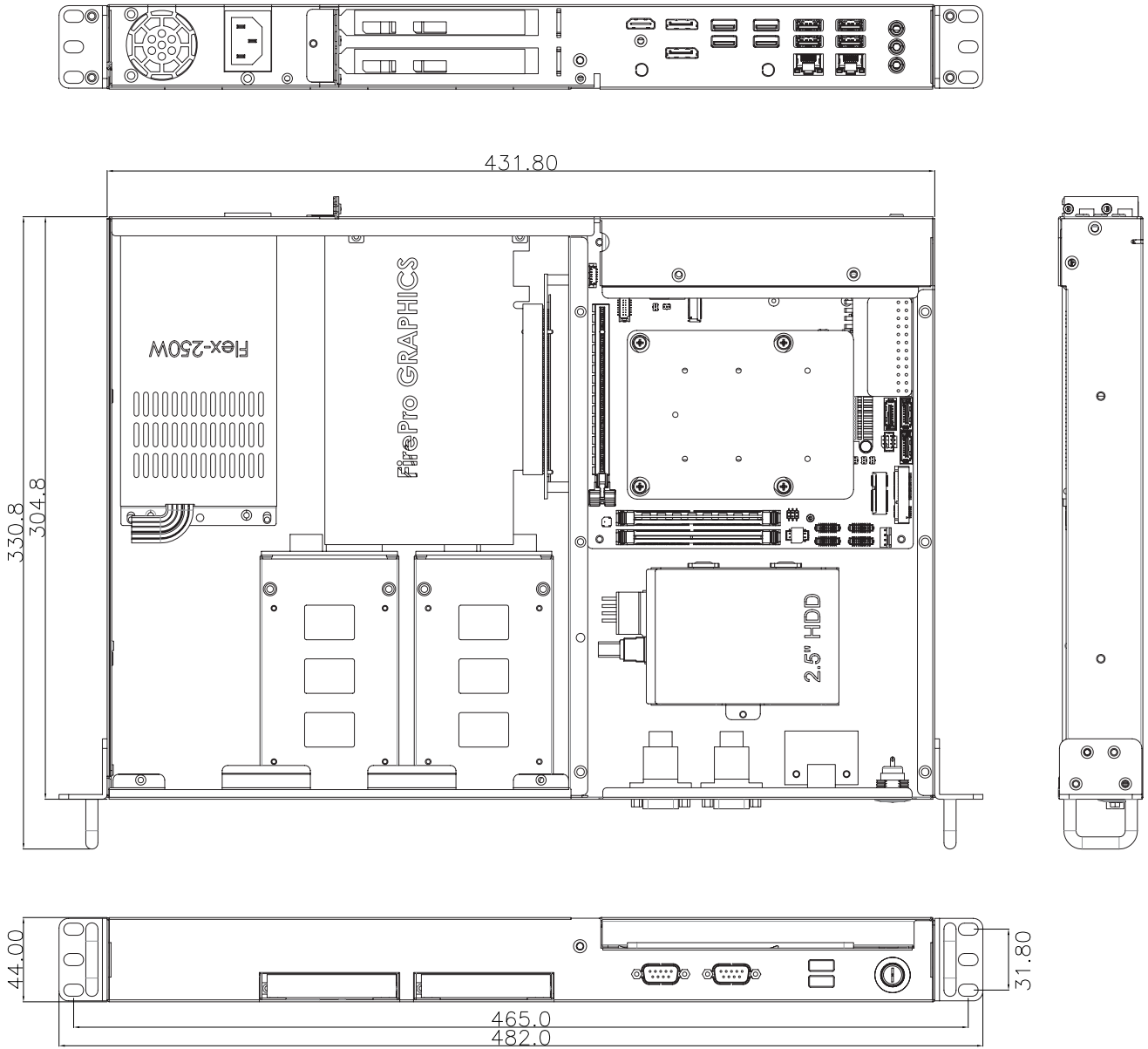

Measurements shown in mm. All dimensions are $\pm 0.5\text{mm}$